

Enterprise Launcher

User Manual

Version <V1.7.4>

Urovo Technology Co., Ltd

Catalog

1. Software overview	1
1.1 Overview	1
1.2 Functions	2
1.3 Performance	3
2. Operating environment	3
3. Instructions.....	3
3.1 Enable software.....	3
3.2 User Interface.....	4
3.3 Administrator login	5
3.4 Administrator interface.....	5
3.5 Administrator settings.....	6
Application management	6
3.5.1 Visitor Launcher Apps.....	6
3.5.2 App white list.....	7
3.5.3 Launch application by default.....	8
3.5.4 Size of application icon.....	8
Devices management	10
3.5.5 WiFi whitelist.....	10
3.5.6 Quick settings tool	12
3.5.7 Access permissions	13
3.5.8Logging	14
Others.....	15
3.5.9 Set launcher title	15
3.5.10 Launcher Wallpaper.....	15
3.5.11 Import.....	16
3.5.12 Export.....	17
3.5.13 Reset Password	18
3.5.14 Administrator exit	18

Statement

The rights of ownership and interpretation of this document belong to Urovo Technology Co., Ltd. Without written permission of Urovo Technology Co., Ltd., it shall not be copied, or disclosed and sold to a third party, otherwise, legal liability will be investigated according to law.

This document is the operation description of the functions of U Stage. The specific operation is subject to the functions of the customer's handheld device. Please read the user manual carefully before using it and standardize the operation.

1. Software overview

1.1 Overview

Enterprise launcher software can maximize the needs of enterprise-side customers for PDA toolings, bring a concise enterprise desktop to the market and customers, restricts access to programs and settings on the device without writing code. Through simple operation, realize the control of the equipment, and provide customers with convenient services.

The enterprise launcher can easily restrict the device to be used by one or more specified applications. It is like a local MDM (Mobile Device Management) and MAM (Mobile Application Management) with reduced functions and has partial Android permissions.

1.2 Functions

Functional modules	Main functions	
User launcher	Workspace	
login	login	
Exit the enterprise launcher	Exit the enterprise launcher from the Home screen app	
App management	Visitor launcher app	
	App white list	
	Launch application by default	
	Size of application icon	
Permission management	WiFi white list	
	Quick setting tool	
	Access permissions	Allow Marketplace installation
		Disable the return key
		Disable the HOME key
		Disables the menu key
		Disables the status bar
		Disable the mobile network
		Disable WiFi
		Disable Bluetooth
		Disable GPS
		Disable USB transfer data
		Disable ADB debugging
	Logging	
Other settings	Set launcher title	
	Set wallpapers	
	Import	Local import
	Export	Export to local
	Reset password	

1.3 Performance

The software has good ease of use and reliability.

2. Operating environment

The software currently supports UROVO DT50 Series, DT40 Series, RT40 Series, I6310 Series, U2 Series and P8100 Series.

3. Instructions

3.1 Enable software

Click Enterprise launcher on the desktop to enable it. After entering the software, it is automatically set as the main screen application. Users can log out the enterprise launcher by pressing the return key before starting. Only administrators can log in to the administrator interface to log out.

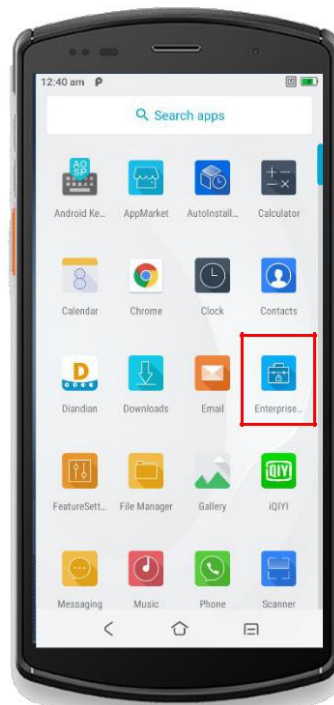

3.2 User Interface

The user interface is the launcher used by the end user of the device, and will display applications that are only available to the user. The application of the user interface is fixed, there is no trigger effect after long press, and cannot be uninstalled. User can click the menu button in the upper right corner to enter the administrator settings interface or view device information. Click the "Start" button to officially enable the enterprise launcher, and users cannot log out.

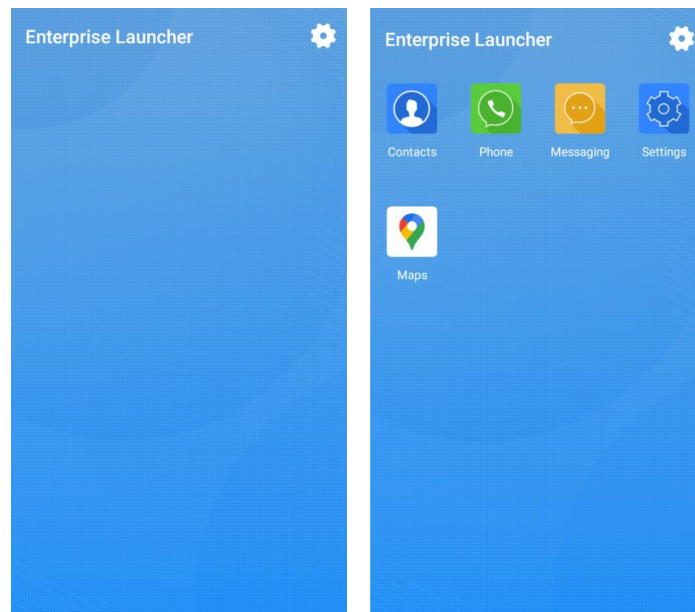

3-2-0 Initial user interface

3-2-1 User interface after configuration

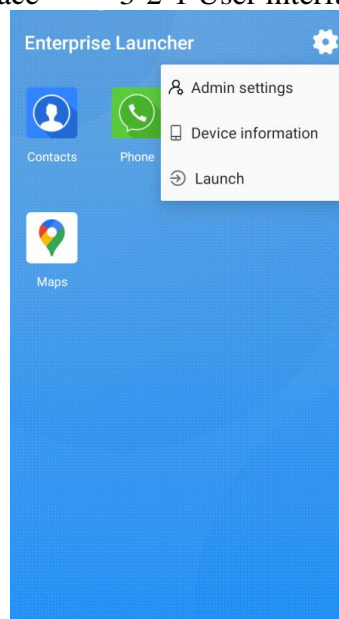

3-2-2 Menu

3.3 Administrator login

Click the menu key in the upper right corner of the user interface to enter the administrator login interface. To enter the administrator interface, you need to confirm the opening of the enterprise launcher, the login password is blank by default when you log in for the first time, and you can modify the password in the administrator settings interface after logging in.

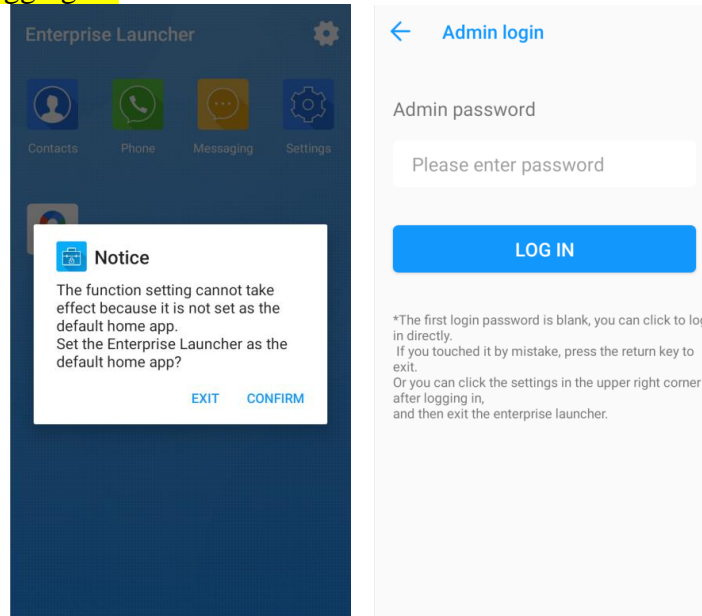

3.3.0 Confirm that Enterprise Launcher is turned on

3-3-1 Administrator login interface

3.4 Administrator interface

The administrator interface displays all the apps on the device, and you can install, uninstall, and view app details.

- (1) Long press the application to pop up the selection bar: application details, uninstall.
- (2) Click the menu button in the upper right corner of the interface to select: administrator settings, device information, and exit enterprise mode.
Administrator settings: enter the administrator settings interface to set the enterprise desktop;

Device information: view device information;

Exit enterprise mode: exit the enterprise desktop and return to the Android launcher;

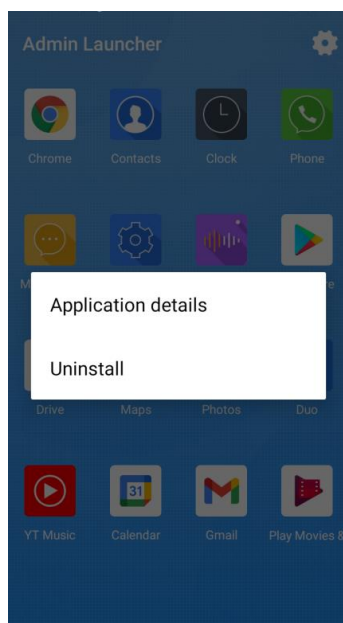

3-4-0 Administrator interface

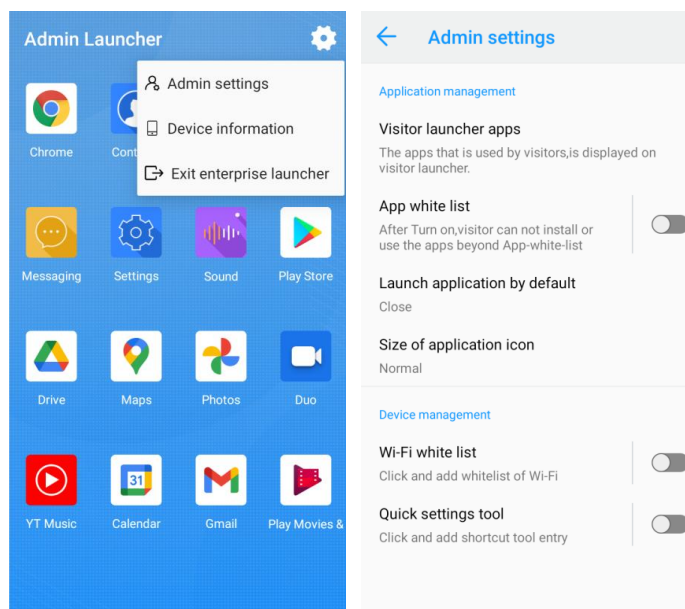

3-4-1 Administrator menu

3-4-2 Administrator setting interface

3.5 Administrator settings

Application management

3.5.1 Visitor Launcher Apps

Click to enter the visitor launcher application, select and open the application switch that needs to be displayed on the visitor launcher in the list. The visitor launcher application list displays all the applications on the device. You can control

the applications displayed on the visitor launcher by turning on the switch or click "Select All" to select all the applications currently on the device to be displayed on the guest launcher for users to use.

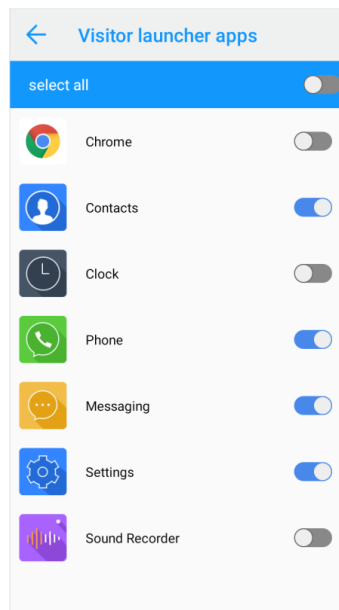

3-5-0 Visitor launcher application

3.5.2 App white list

Click the app white list and select the whitelist application as the user interface application in the list. Only whitelisted applications can be used in the user interface, non-whitelisted applications will not be displayed, and non-whitelisted applications cannot be installed.

The whitelisted application list displays all the applications on the device. By turning on the switch to control the whitelisted applications or clicking "Select All", which is selecting all the applications currently on the device as the whitelisted applications and displaying them on the user interface for users to use.

Note: When the whitelist application switch is turned on, if a third-party application is installed on the device, and the third-party application is not added when adding the visitor desktop application to be displayed on the visitor desktop, the application will uninstall the non-whitelisted third-party application after returning to the user's desktop.

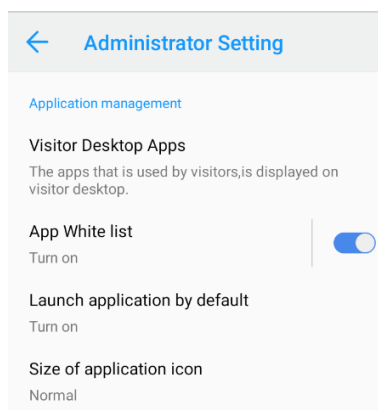

3-5-1 App white list switch

3.5.3 Launch application by default

The default application automatically opens the application after each boot. In the selected whitelist applications, select one as the default application.

The default is off, and the default application will not take effect after the device is turned on. After turning on the default application switch, select an application from the list below as the default application.

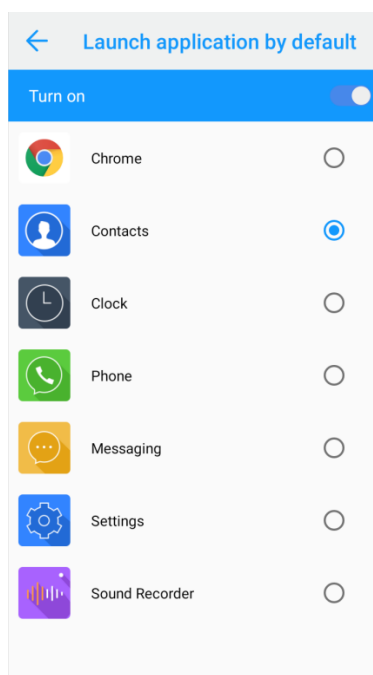

3-5-2 Launch application by default

3.5.4 Size of application icon

Click the size of application icon to set the size of the icon displayed on the user interface. The default is the normal size.

There are four levels of icon size to choose from: small, regular, large, and extra large;

Small: 5 icons in a row

Conventional: 4 icons in a row

Large: 3 icons in a row

Very large: 2 icons in a row

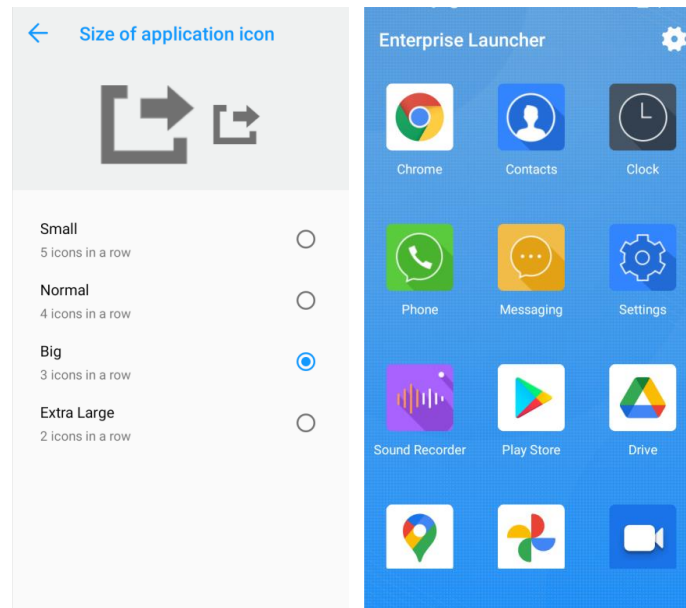

3-5-3 Icon size

3-5-4 Icon size: small

Devices management

3.5.5 WiFi whitelist

The WiFi whitelist is to restrict the WiFi connected to the device. After turning it on, the WiFi setting list will only display and connect to the SSID in the whitelist. The WiFi whitelist switch is set to off.

The whitelist SSID can only be checked when the switch is off or click the "+" in the upper right corner to manually add the SSID. After clicking and adding the whitelist, turn on the switch, the WiFi list only displays the added whitelist, and only SSIDs in the whitelist can be connected. If you do not add a whitelist, the whitelist function will not take effect after opening. Note: When adding WiFi whitelist, GPS service needs to be turned on.

Note: 1. If you do not add a whitelist, the whitelist function will not take effect after opening.

2. When adding WiFi whitelist, GPS service needs to be turned on.

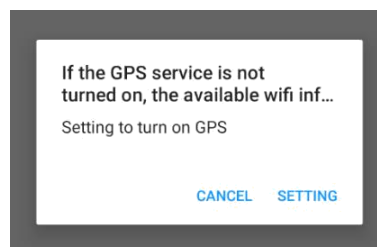

3-5-5 GPS Service information

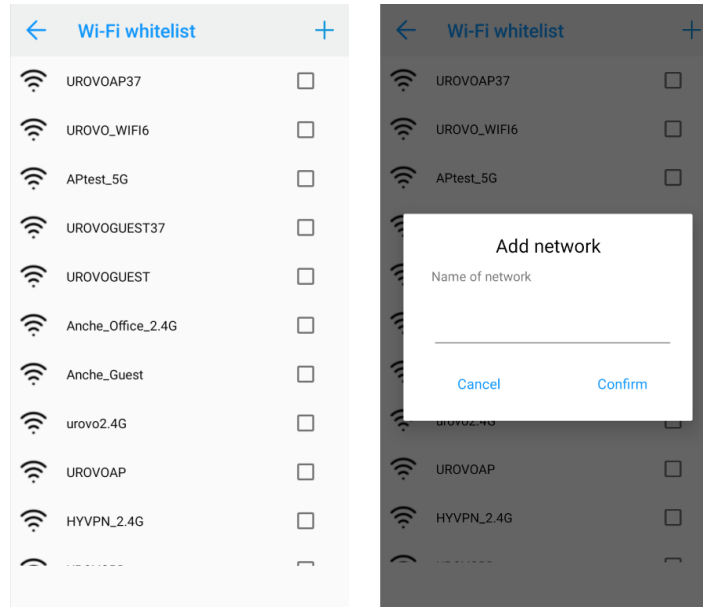

3-5-6 Add WiFi whitelist

3-5-7 Add SSID manually

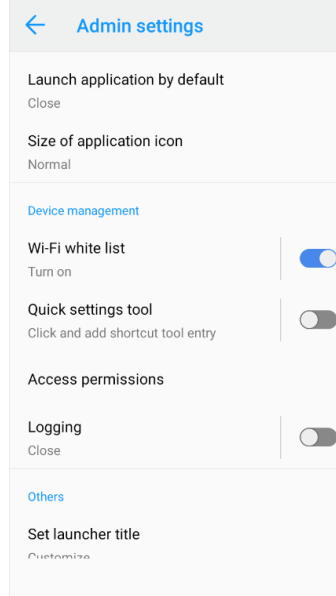

3-5-8 Open WiFi whitelist

3.5.6 Quick settings tool

You need to select quick setting entry and turn on setting contents of quick settings tool. On the user interface, you can quickly enter the screen for setting mobile network, WiFi, Bluetooth, Sound, and Display.

If the quick settings tool is enabled, after the mobile network, WiFi and Bluetooth are disabled in 3.5.7 Access permissions, the open button of quick settings tool will be automatically closed, and the button does not take effect in clicking when it is gray, and the disable can be cancelled before clicking.

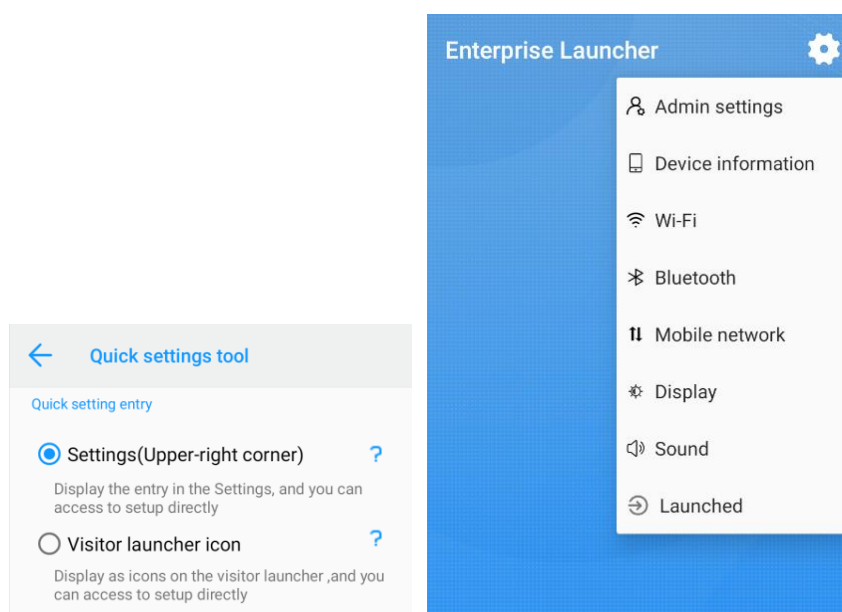

3.5.9 Select Quick setting entry

3.5.10 Select Quick setting entry - Settings (Upper-right corner)

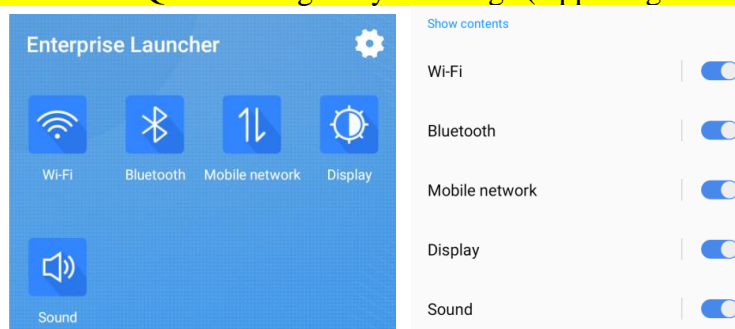

3.5.11 Select Quick setting entry - Visitor launcher icon

3-5-12 Turn on setting contents of quick settings tool

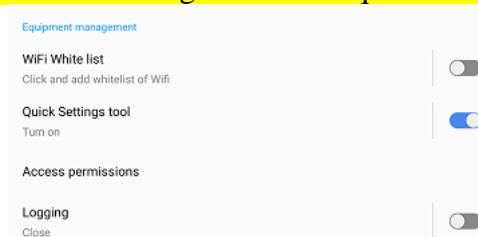

3-5-13 Turn on Quick settings tool

3.5.7 Access permissions

The customer can disable navigation bar, status bar, mobile network, WIFI, Bluetooth, GPS, USB data transfer, and ADB debugging by setting permissions.

Allow app market installation: After enabled, the apps downloaded from the app market and those remotely deployed by the UMS are directly displayed on the visitor launcher;

Disable the left key: After disabled, the left key in the navigation bar at the bottom of the screen does not take effect when clicking;

Disable the middle key: After disabled, the middle key in the navigation bar at the bottom of the screen does not take effect when clicking;

Disable the right key: After disabled, the right key in the navigation bar at the bottom of the screen does not take effect when clicking;

Disable status bar: Disable pull-down status bar;

Disable mobile network: Prevent the device from using the mobile network;

Disable WIFI: It is forbidden to set the use of WIFI, cannot turn on the WIFI switch and cannot connect to WIFI;

Disable Bluetooth: prohibit the use of Bluetooth;

Disable GPS: Prohibit the use of GPS, unable to open the location information switch;

Disable USB data transfer: USB debugging is prohibited;

Disable ADB debugging: prohibit the use of ADB debugging;

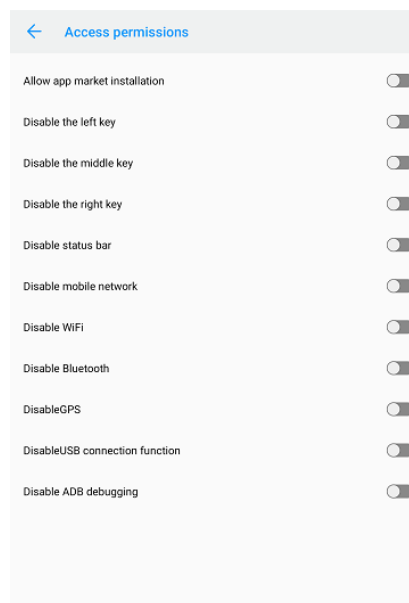

3-5-14 Access Permissions interface

3.5.8Logging

Log records are used to capture system logs. Click Logging to set the maximum log size. Turn on the switch and start to capture logs, which are saved in the sdcard/Ulog/logs/adb directory.

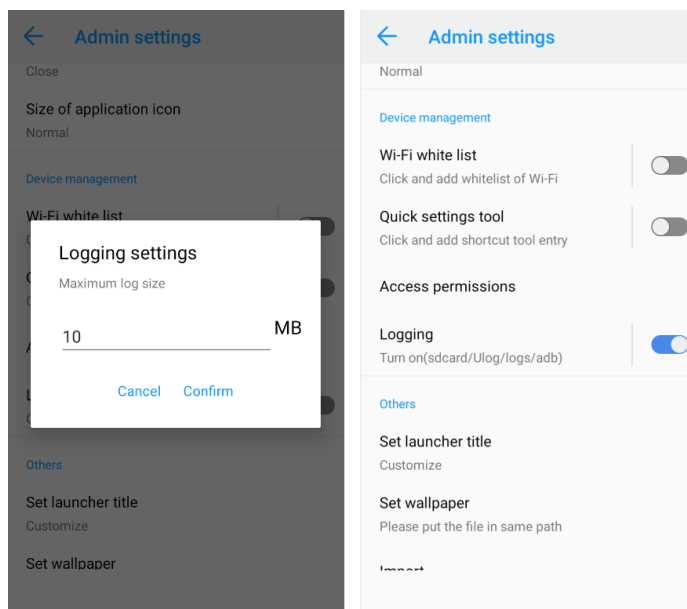

3-5-15 Log record size

3-5-16 Logging on

Others

3.5.9 Set launcher title

"Customize": You can enter custom characters as the launcher title (default Enterprise Launcher). Limit the maximum input character to 16 characters;

"Model": Display the device model as the title;

"Serial number": Display the SN of the device as the title;

After editing, click Confirm to edit successfully.

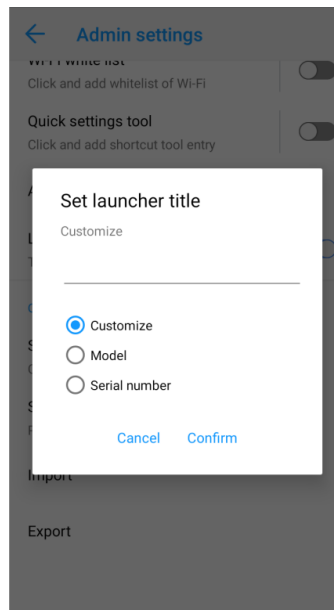

3-5-17 Set launcher title

3.5.10 Launcher Wallpaper

Click on the launcher wallpaper, in the pop-up folder interface, select the launcher wallpaper that needs to be replaced.

Note: 1. The selected launcher wallpaper only takes effect on the visitor interface;

2.The configuration file exported by device A will not include the wallpaper file, so when device B is imported, the wallpaper file needs to be placed in the same wallpaper path as device A;

3. The wallpaper image format supports JPG/PNG/BMP format.

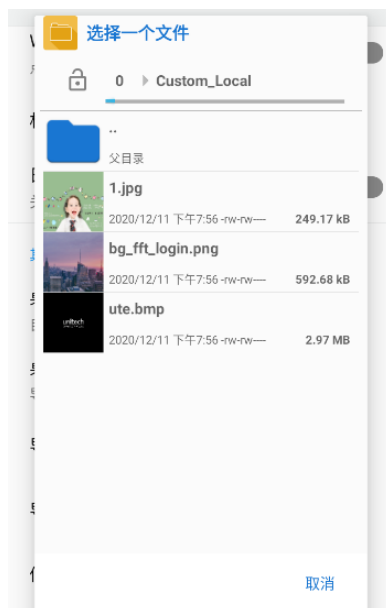

3-5-18 Set desktop wallpaper

3.5.11 Import

Import can realize the unified deployment of multiple devices. Import the configuration file exported from device A to other devices to realize the deployment of multiple devices. The content that supports importing is the enterprise launcher administrator login screen and enterprise launcher settings.

(1) Automatic configuration file import

Open the corporate launcher, place the exported configuration file "settings_property.json" in the Custom_Local folder, restart the device and wait for the configuration file to take effect.

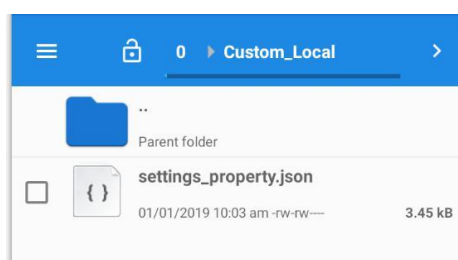

3-5-19 sdcard/Custom_Local

(2) Local import

Click Local import, select the imported configuration file in the pop-up folder, and wait for the pop-up prompt "Configuration File Import Successfully" to make the configuration effective.

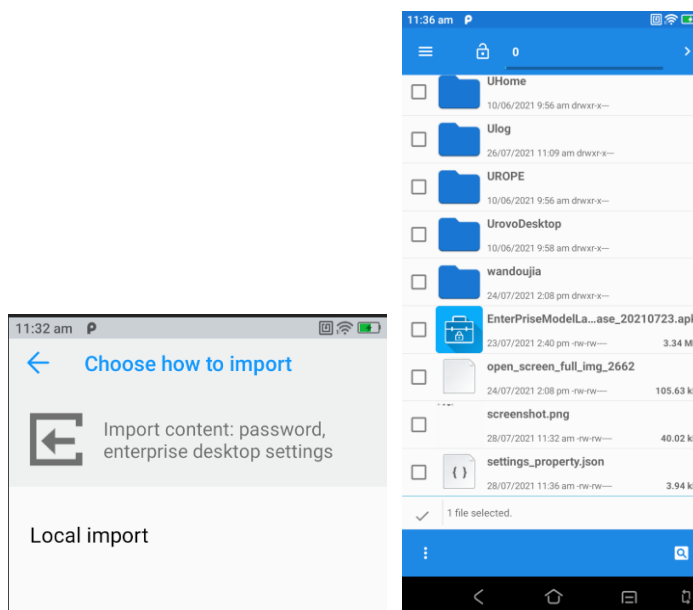

3-5-20 Import

3-5-21 Import profile

3.5.12 Export

Export can export the enterprise launcher configuration in the device. The contents of the enterprise launcher that can be exported are: administrator login password, enterprise launcher settings.

Click Export to local, and wait for a prompt at the bottom of the screen: "Configuration file exported successfully". The successfully exported file is saved in settings_property.json in the sdcard/Custom_Local directory.

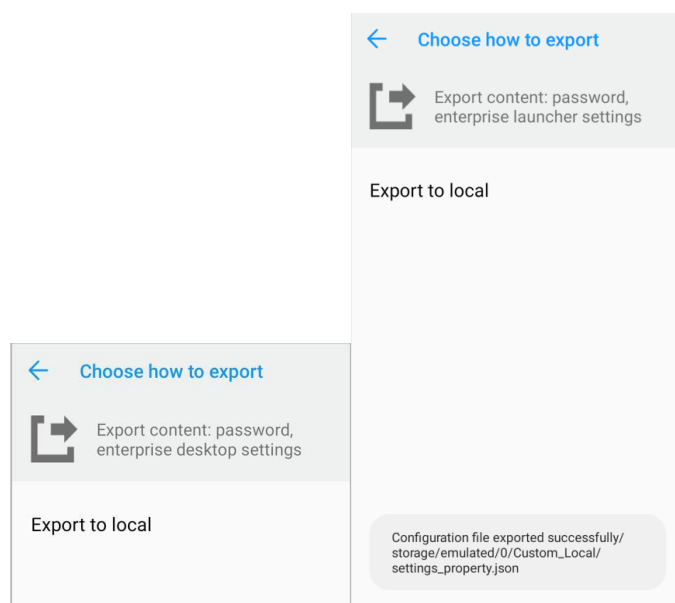

3-5-22 Export

3-5-23 Export successfully

3.5.13 Reset Password

The administrator password can be modified. The password can enter letters, numbers, and special characters.

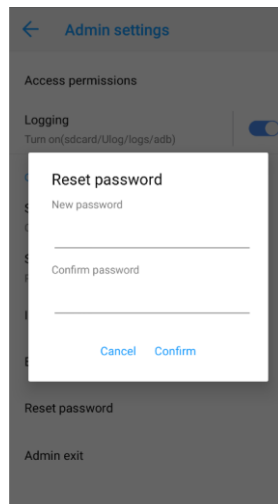

3-5-24 Reset Password

3.5.14 Administrator exit

Click to exit the administrator mode and return to the user interface. After exiting, user needs to enter a password to enter the administrator interface.