



---

## Update to "Invoicing" and "All Packing Slips" Pages

Do you find yourself asking, "Why can't I invoice for my parts?" or, "Why can't I complete parts when they're already invoiced?" after creating a blanket order?

This update flags parts that need review and gives you **action steps to easily resolve** issues.

- **New tab** in the Invoicing dashboard called "Cannot Invoice Parts" brings you to parts that need to be marked Completed.

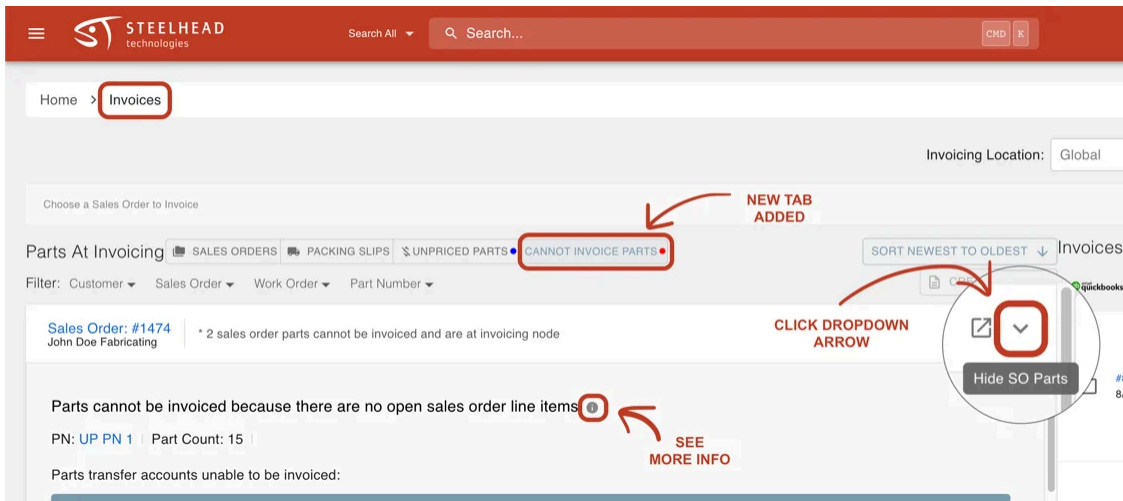

- **New button** on the "All Packing Slips" page helps you quickly and easily locate and complete parts.

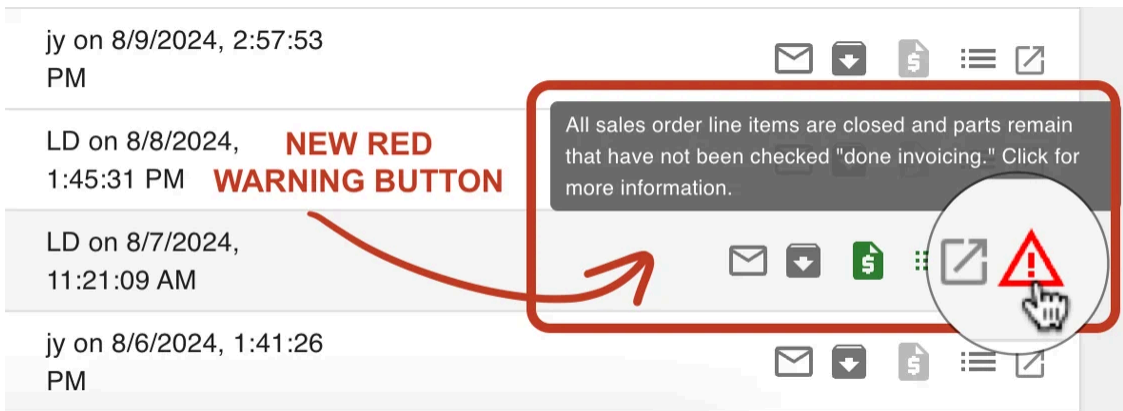

Want a **quick explanation** of this update? **Click the video** below to see how it helps you with invoicing and completing parts.

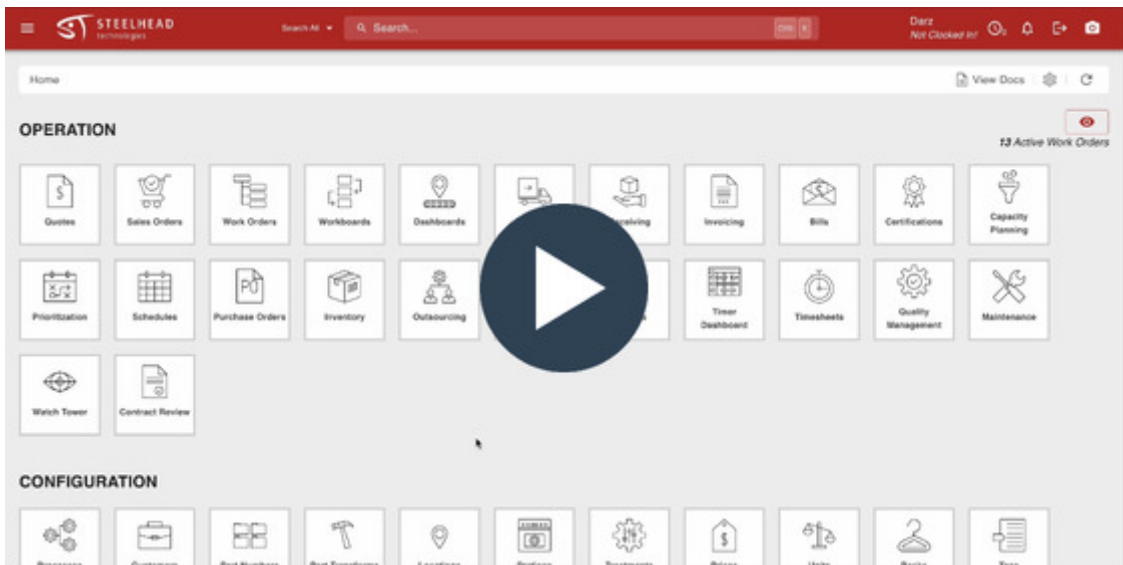

# Upcoming: New and Improved Specs & Certs

**Expected Release: End of August, 2024**

Steelhead will be releasing a major update to Specs and Certs at the end of August. This update will enhance the workflow when moving Parts with specs.

Improvements to processing parts with Specs will include:

- Spec Measurements associated to a Part Transfer Account, allowing for **more specificity**.
- A new button to **easily Split and Reallocate** measurements.

The update will also introduce improvements to Cert creation workflows, including:

- Creating and finalizing a Certification in **just a few clicks**.
- More precise Certs that can **include or exclude certain measurements**.
- **Certifying Partial Shipments**.
- Replacement of Master Certs with a more efficient way to **certify multiple part accounts at once**.
- The number bubble on packing slips in Shipping dashboard will now be based on Part Transfer Accounts.

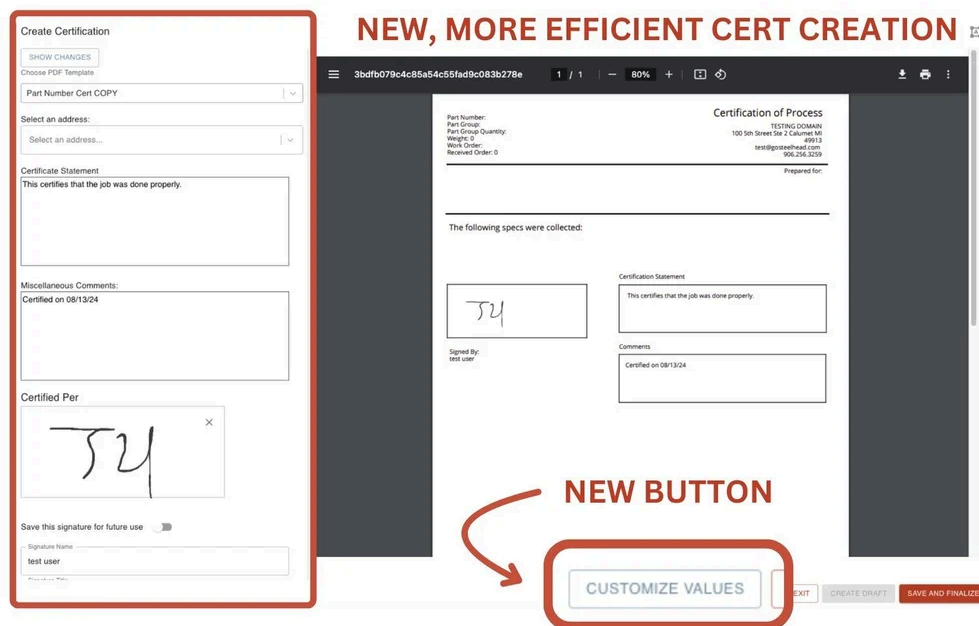

More information about this update, including documentation and video tutorials, will be available in the next week. Watch for further product updates in your inbox prior

to the end of the month.

---

## Product Update Highlights

### Sales Tax Default on Invoices

When creating an invoice, Sales Tax will be pulled in based on the tax code associated with the default "Ship To" address, if there is one.

### Create Multiple Packing Slips at Once

This feature allows users to create a packing slip per container in the Create Packing Slip dialogue box.

### Inventory Insights

New Expiration Date column on Inventory Reports in Insights (Inventory Over Time and Inventory on Hand).

### Sales Order Audit Log Includes Timestamp

After closing a Sales Order Line Item, a timestamp in the Audit Log will show the date & time it was closed, giving a more comprehensive line item history.

### Invoiced Margins and Sales Order Margins Displayed

This shows and logs discrepancies between original sales order prices and final invoice amounts.

[VIEW ALL PRODUCT UPDATES](#)

---

PROUD PARTNER OF



Steelhead Technologies, 100 5th Street, Suite 2, Calumet, MI 49913, United States

[Unsubscribe](#) [Manage preferences](#)