



Specs and Certs Update To Be Released Soon

On **Sunday, September 8th 2024**, Steelhead will be releasing an update to Specs and Certs.

The major change with this update is that Spec Measurements will now be associated to a Part Transfer Account, rather than a Work Order/Part Number combination, giving you the **ability to get more specific and the option to edit Specs**.

[Click the video](#) for a walkthrough of the update!

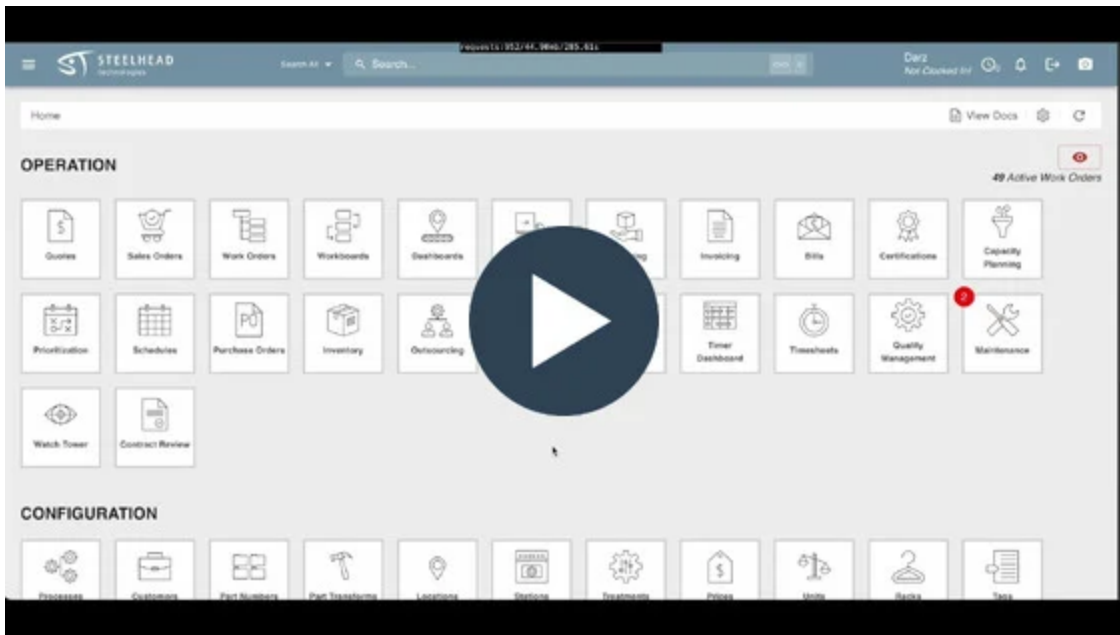

The following improvements to Specs will give you more flexibility and specificity:

- A new button will allow you to **easily Split Spec Measurements** and Reallocate to Parts. ([Click Here for Step-by-Step Instructions](#))
- You will be able to **resolve multiple failed Spec measurements** with one Resolution Comment. ([Click Here for Step-by-Step Instructions](#))
- The dialog box has been updated for the "COLLECT ADDITIONAL" button, allowing you to **specify which Part Account** the measurement is applied to. ([Click Here for Step-by-Step Instructions](#))

COLLECT ADDITIONAL

Collect Spec Information

Spec Field: SF (number) Param Name: param Input: Required

Minimum Value: 1 Maximum Value: 10 Target Value: N/A

Spec Field Param Description:
enter a number

Value:

Comment:

Select a Part Account

Select	Part	Station	Work Order	Rack	Recipe Node	Max Part Count
<input type="checkbox"/>	17" Aluminum Wheel	Oven 1	4490		Cure	1
<input type="checkbox"/>	17" Aluminum Wheel	Oven 1	4490		Cure	10
<input type="checkbox"/>	17" Aluminum Wheel	Oven 1	4490		Cure	7

ASSIGN SPEC VALUES TO
INDIVIDUAL PART ACCOUNTS

CANCEL
SAVE

The workflow for creating Certificates will allow for more customization and efficiency. These changes include:

- The ability to create and finalize a Cert in **fewer clicks**.
- The option to **include and exclude Spec Measurements** on Certs.
- A more efficient way to **certify multiple Part Accounts** at once, which will be a replacement for Master Certs.
- The ability to **certify Partial Shipments**.

[\(Click Here for Updated Cert Creation Instructions\)](#)

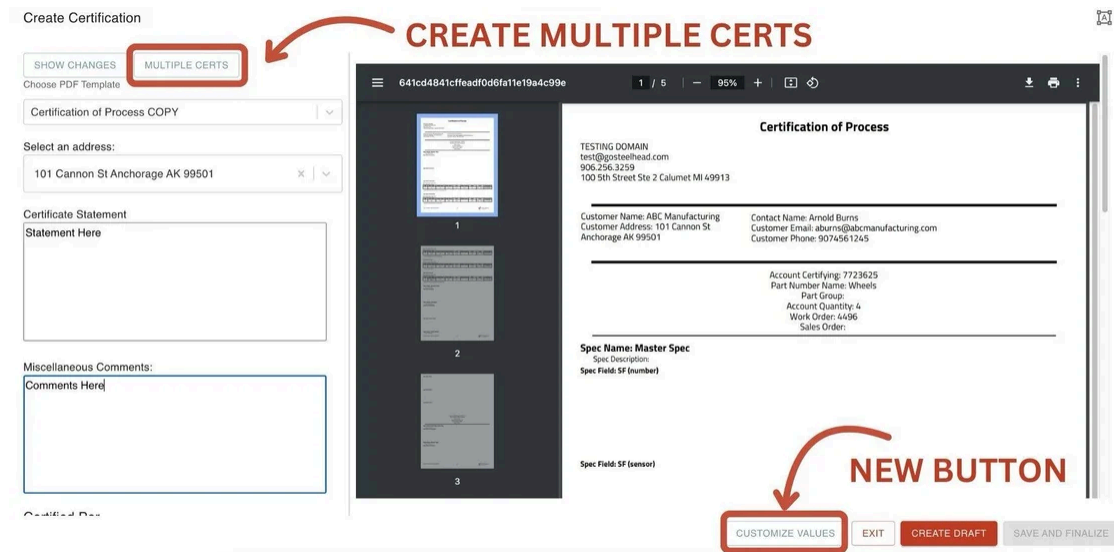

We hope that these updates will help you save time and have your shop running more efficiently. Again, this update is planned for release on September 8, 2024.

Please reach out to your Customer Success Manager or email us at support@gosteelhead.com with any questions!

New Courses in Steelhead University

Ensure your *whole* team knows how to use Steelhead effectively!

We've recently published three new courses in Steelhead University:

- "Initial Data Import" Course helps you get your data imported into Steelhead to transition smoothly from the workflows you used previously.
- "Customer Portal" Course shows you how to set up general default permissions and customer specific permissions in Steelhead, plus gives an

overview of what the Customer Portal looks like and shows what your customers see on their side of the Portal.

- "Receiving" Course walks you through receiving Parts in Steelhead. It goes over the different buttons and functions of Customer Parts versus the Purchase Order side, what Received Batches are and how to receive Customer Parts.

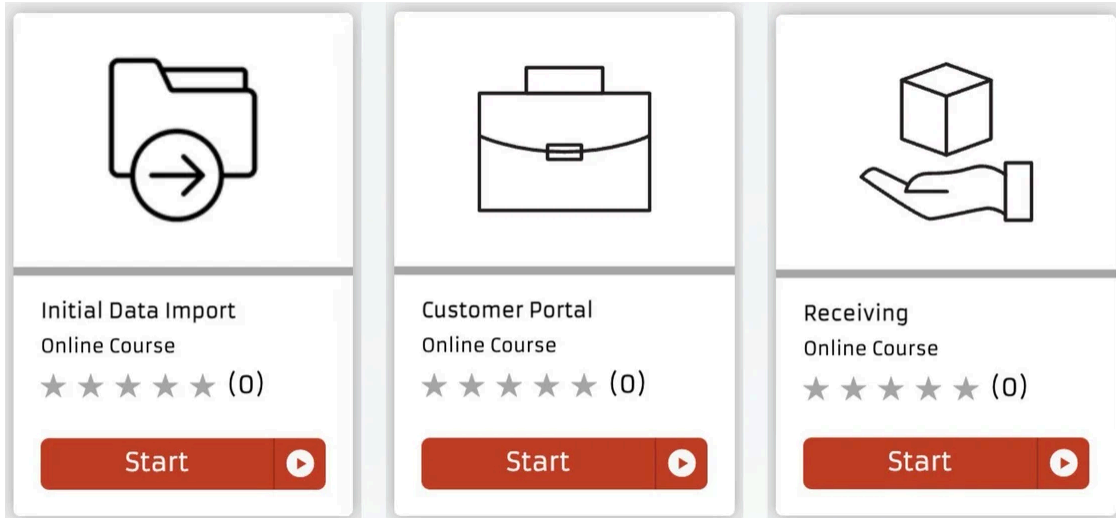

To enroll yourself or your team in Steelhead University, email learn@gosteelhead.com.

Coming Soon:

Update to Contract Review for Spec-Related Recipes

With this update, you'll be able to correct order entry mistakes on Specs during Contract Review. It will allow you to go back and adjust the opt-in/opt-out settings and change selected Specs.

This update is nearing completion and will be released soon. We will provide more information including documentation and video demonstrations as they become available leading up to the launch. Until then, contact your Customer Success Manager or support@gosteelhead.com with any questions.

Product Update Highlights

Now View Sent Purchase Order Emails

Enabled users to view if an email has been sent for a Purchase Order. You may also email Purchase Orders from the Outsourcing screen.

Boolean Spec Measurements

Boolean Spec Measurements now have a Pass/Fail button instead of a checkbox.

Search for Parts with Empty/ Blank Location in Watch Tower

Now allows you to select a "No Location" checkbox to filter your search when searching for Parts.

Add Specs and Params to Work Order from Recipe Composer

This lets you resolve errors in Specs and Recipes at the same time when using spec-driven processing.

VIEW ALL PRODUCT UPDATES

Steelhead Technologies, 100 5th Street, Suite 2, Calumet, MI 49913, United States

[Unsubscribe](#) [Manage preferences](#)